

What are your accommodation options?



ROYAL
HOLLOWAY
UNIVERSITY
OF LONDON

Find out what your accommodation options are with this quick flowchart.

On page 1 pick the most important thing to you when thinking about university halls. Click on the box, or follow the coloured line down to the corresponding page.

From there, make your choices about what you would like out of accommodation and you will be matched with the halls which best fit your requirements. Click on the box to learn more about the band you have been matched with.

Feel free to take the quiz as many times as you like to see the various options we offer!

For any terms you don't understand, check out the glossary at the start of the quiz.

Glossary of terms:

30/38 week contract: The length of time you can stay in halls. 30 week contracts tend to be lower cost, but require you to move out of your room during the Christmas and Easter break. You will move back into the same room after each break.

Catered: Instead of having a full kitchen and cooking for yourself, you have access to a pantry, and will take your meals in the Founder's dining hall, the Hub, or KW's. Our catered system is pay as you go, which means you top up your student card with money and receive a 50% discount off food (+20% VAT) from designated dining halls.

En suite: Your bedroom has access to your own bathroom, which includes a shower, sink, and toilet.

Halls of residence: Our student accommodation is often referred to as Halls of Residence, or Halls.

Pantry: Catered accommodation has access to a pantry instead of a full kitchen where residents can prepare hot drinks and light snacks. The pantries include fridge space, toaster, kettle, microwave, sink and table and chairs.

Self-catered: Self-catered halls have full kitchens fitted, including fridge and freezer space, access to an oven and hob, and sink.

Single gendered: These halls are split into all male or all female corridors.

Low annual cost: When discussing a low cost, please note we are considering the overall cost of accommodation for the year rather than the cost per week. For longer tenancies, the cost may be lower per week but higher in total.

What is the most important factor for you when picking accommodation?

My own
bathroom

Single
gendered
hall

Lower
annual
cost

Not cooking for
myself

Not moving out
during
the holidays

Parking
my car

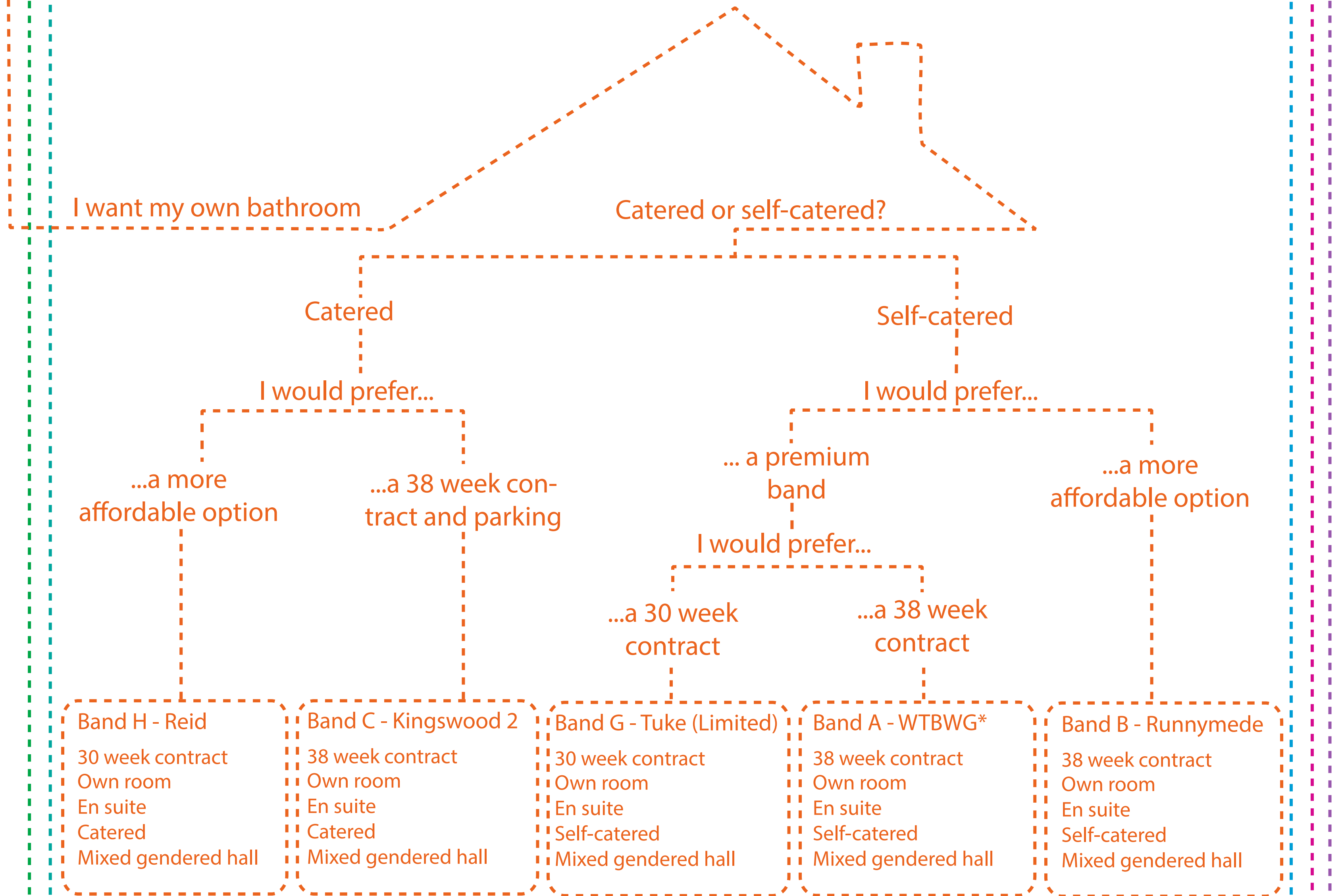

Band H - Reid
 30 week contract
 Own room
 En suite
 Catered
 Mixed gendered hall

Band C - Kingswood 2
 38 week contract
 Own room
 En suite
 Catered
 Mixed gendered hall

Band G - Tuke (Limited)
 30 week contract
 Own room
 En suite
 Self-catered
 Mixed gendered hall

Band A - WTBWG*
 38 week contract
 Own room
 En suite
 Self-catered
 Mixed gendered hall

Band B - Runnymede
 38 week contract
 Own room
 En suite
 Self-catered
 Mixed gendered hall

*WTBWG - Williamson, Tuke, Butler, Wedderburn, Gowar: 38 week contract

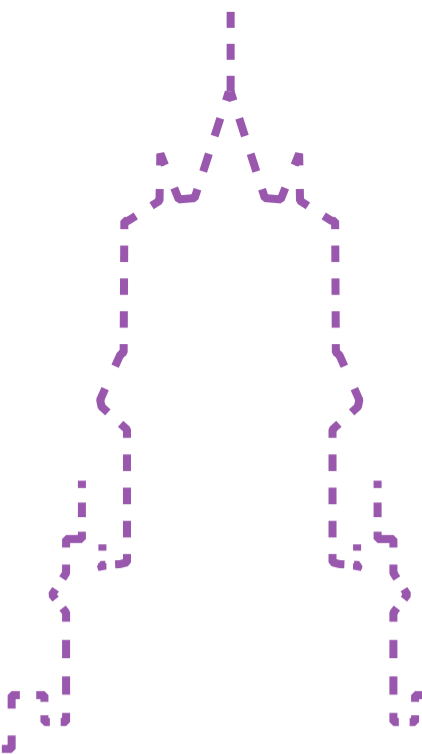

I want a lower annual cost

Shared room or own

Own room

Shared room

I would prefer...

...en suite

...a more affordable option

Catered or self-catered?

30 or 38 week contract?

Self-catered

Catered

30 weeks

38 weeks

30 or 38 week contract?

30 weeks

38 weeks

Band L - Founder's

30 week contract
Shared room
Catered
Single gendered hall

Band G - Tuke (limited)

30 week contract
Own room
En suite
Self-catered
Mixed gendered hall

Band H - Reid

30 week contract
Own room
En suite
Catered
Mixed gendered hall

Band C - Kingswood 2

38 week contract
Own room
En suite
Catered
Parking
Mixed gendered hall

Band E - Kingswood 1

38 week contract
Own room
Catered
Parking
Single gendered hall

Band K - Kingswood 1

38 week contract
Shared room
Catered
Parking
Single gendered hall

I want to stay in halls during the holidays

Catered or self-catered?

Catered

Self-catered

I would prefer...

I would prefer...

...a more affordable option

...an en suite

...a premium band

...a more affordable option

Own room or shared room?

Own room

Shared room

...en suite

...a newer build

Band B - Runnymede

38 week contract
Own room
En suite
Self-catered
Mixed gendered hall

Band E - Kingswood 1

38 week contract
Own room
Catered
Parking
Single gendered hall

Band K - Kingswood 1

38 week contract
Shared room
Catered
Parking
Single gendered hall

Band C - Kingswood 2

38 week contract
Own room
En suite
Catered
Parking
Mixed gendered hall

Band A - WTBWG*

38 week contract
Own room
En suite
Self-catered
Mixed gendered hall

Band D - George Eliot
(New for 2017/18)

38 week contract
Own room
Self-catered
Mixed gendered hall

*WTBWG - Williamson, Tuke, Butler, Wedderburn, Gowar: 38 week contract

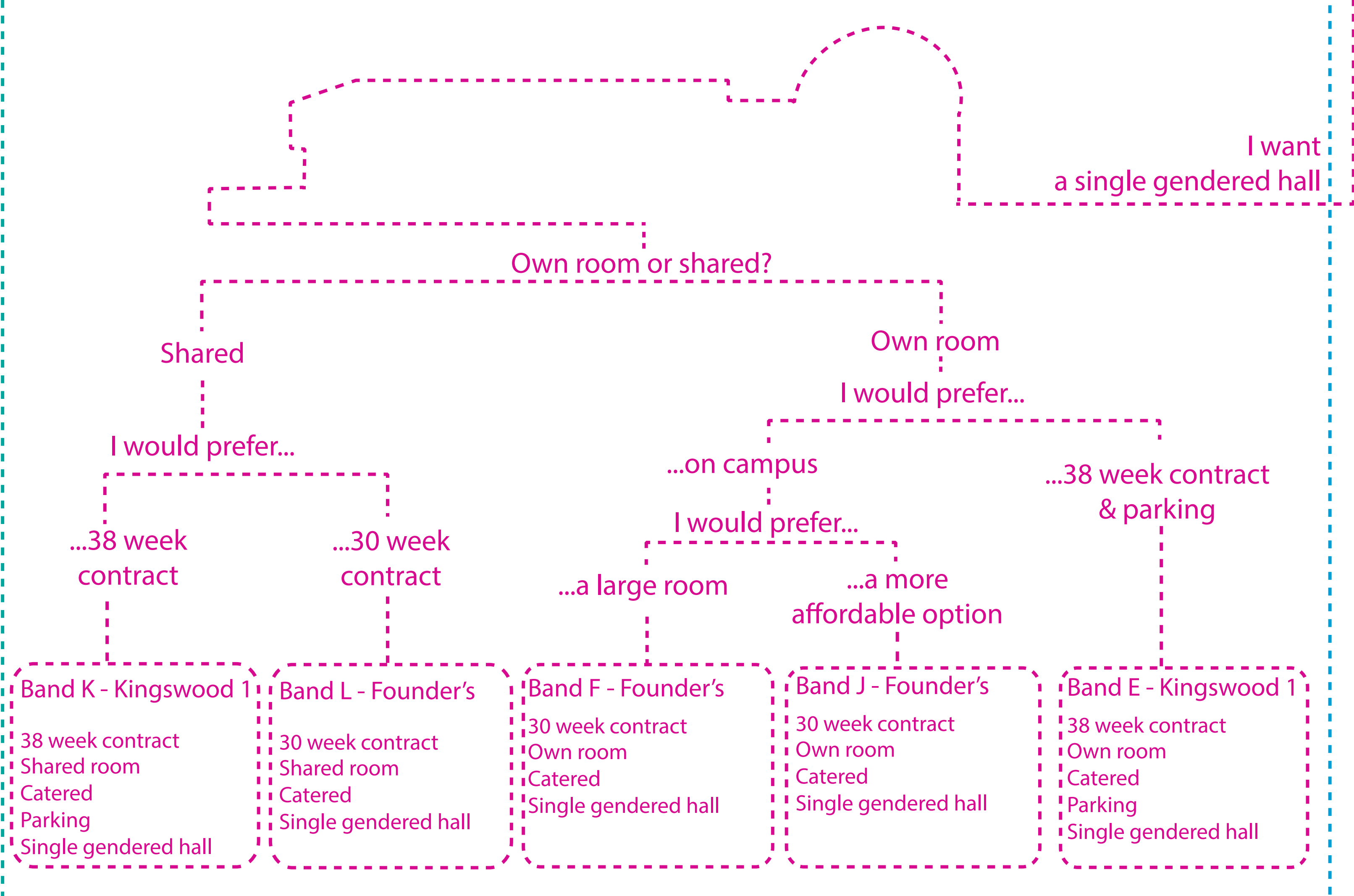

I want a single gendered hall

Own room or shared?

Shared

Own room

I would prefer...

I would prefer...

...38 week contract

...30 week contract

...on campus

...38 week contract & parking

I would prefer...

...a large room

...a more affordable option

Band K - Kingswood 1

Band L - Founder's

Band F - Founder's

Band J - Founder's

Band E - Kingswood 1

38 week contract
Shared room
Catered
Parking
Single gendered hall

30 week contract
Shared room
Catered
Single gendered hall

30 week contract
Own room
Catered
Single gendered hall

30 week contract
Own room
Catered
Single gendered hall

38 week contract
Own room
Catered
Parking
Single gendered hall

I want catered accommodation



I would prefer...

...an en suite

...a more affordable option

I would prefer...

I would prefer...

...38 week contract & parking

...a more affordable option

...38 week contract & parking

...a 30 week contract

Own room or shared?

Own room or shared?

Own room

Shared room

Own room

Shared room

Band C - Kingswood 2

- 38 week contract
- Own room
- En suite
- Catered
- Parking
- Mixed gendered hall

Band H - Reid

- 30 week contract
- Own room
- En suite
- Catered
- Mixed gendered hall

Band E - Kingswood 1

- 38 week contract
- Own room
- Catered
- Parking
- Single gendered hall

Band K - Kingswood 1

- 38 week contract
- Shared room
- Catered
- Parking
- Single gendered hall

Band J - Founder's

- 30 week contract
- Own room
- Catered
- Single gendered hall
- Band F - Founder's Large
- 30 week contract
- Own room
- Catered
- Single gendered hall

Band L - Founder's

- 30 week contract
- Shared room
- Catered
- Single gendered hall

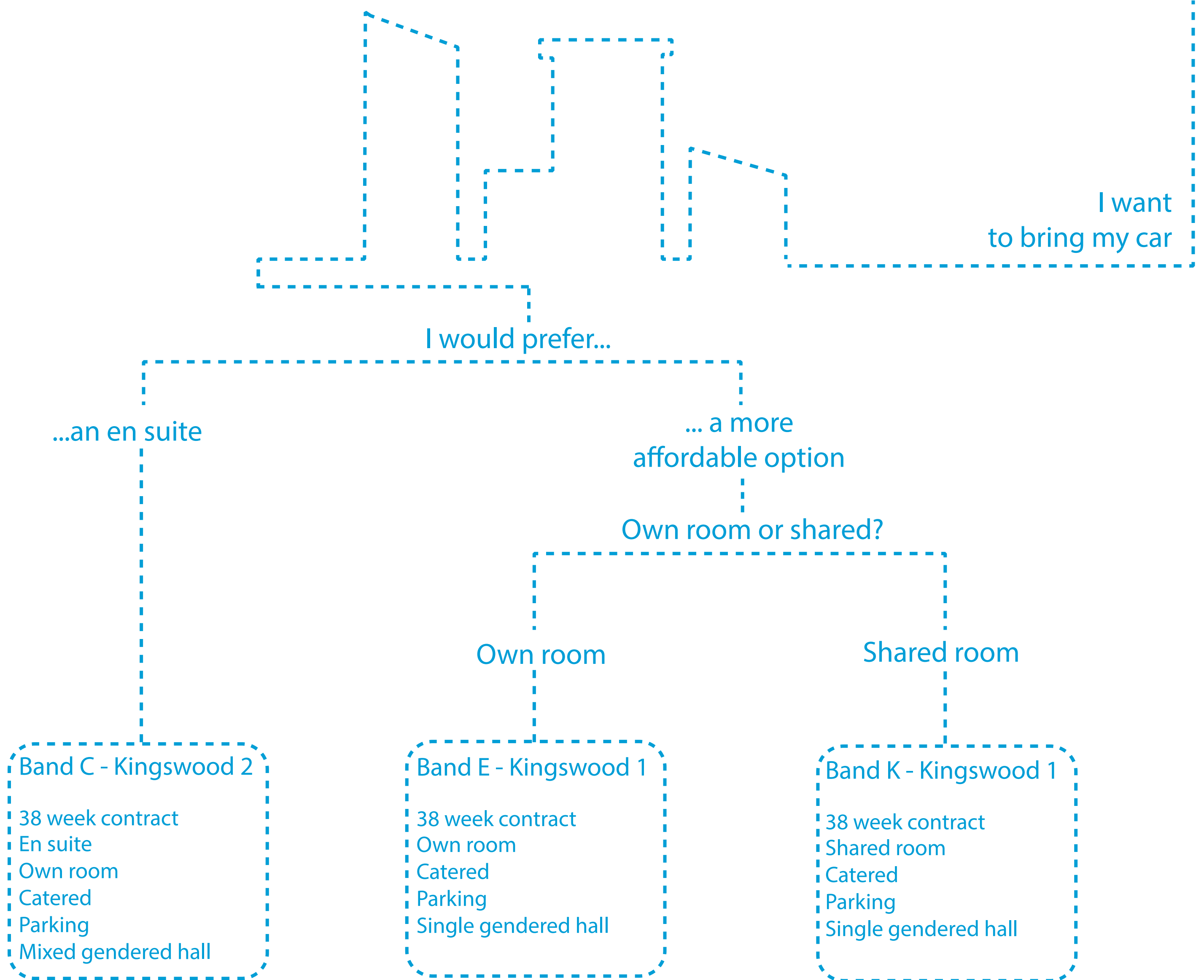

Premium plus Band A - Williamson, Tuke, Butler, Wedderburn & Gowar

Undergraduates only

Flats of 6 - 8 people

Mixed gendered

38 week contract

Single room only (no sharing)

En suite wetroom

Double bed as standard (some rooms may vary)

Self-catered with full kitchen

Wireless and Ethernet access in all rooms

£6,418.30 (or £168.90 per week)



Premium Band B - Runnymede 1 & 2

Undergraduates only

Flats of 6 or 8 people

Mixed gendered

38 week contract

Single room only (no sharing)

En suite bathroom

Self-catered with full kitchen

Wireless and Ethernet access in all rooms

£5,933.35 (or £156.14 per week)



Band C - Kingswood 2

Undergraduates only

Flats of 6 or 9 people

Mixed gendered

38 week contract

Single room only (no sharing)

En suite bathroom

Catered pay-as-you-go with a shared pantry

Parking available

Off campus

Student bar 8Barg, TV/common room, computer room, and squash and tennis courts

Wireless and Ethernet access in all rooms

£5,363.60 (or £141.15 per week)



Band D - George Eliot Halls

BRAND NEW FOR 2017/18

Undergraduates and Postgraduates

Townhouses of 8 to 12 people

Mixed gendered

38 week contract for undergraduates

Single room only (no sharing)

Double bed

Self-catered, with full kitchen

Communal dining and living areas

Wireless and Ethernet access in all rooms

£6,418.30 (or £168.90 per week)



Band E - Kingswood 1

Undergraduates only

Single gendered

38 week contract

Single room only (no sharing)

Communal bathroom

Catered pay-as-you-go with a shared pantry

Parking available

Off campus

Washbasin available

Student bar 8Barg, TV/common room, computer room,
and squash and tennis courts

Wireless and Ethernet access in all rooms

**£4,062.45 (or £106.91 per week) to
£4,250.60 (or £111.86 per week)**



Band F - Founder's Large

Undergraduates only

Single gendered

30 week contract

Communal bathroom

Single room only (no sharing)

Catered pay-as-you-go with a shared pantry

Wireless and Ethernet access in all rooms

£5,311.62 (or £177.01 per week)



Band G - Tuke F (Limited availability)

Undergraduates only

Mixed gendered

Double bed

Flats of 8 people

30 week contract

En suite bathroom

Single room only (no sharing)

Self-catered with access to a full kitchen

Wireless and Ethernet access in all rooms

£5,313.69 (or £177.12 per week)



Band H - Reid

Undergraduates only

Mixed gendered

Houses of 12 people

30 week contract

En suite bathroom

Single room only (no sharing)

Catered, pay-as-you-go with a shared pantry

Wireless and Ethernet access in all rooms

£4,847.94 (or £161.60 per week)



Band J - Founder's Single

Undergraduates only

Single gendered

30 week contract

Communal bathroom

Single room only (no sharing)

Catered pay-as-you-go with a shared pantry

Wireless and Ethernet access in all rooms

**£4,456.71 (or £148.56 per week) to
£4,514.67 (or £150.49 per week)**



Band K - Kingswood 1 Shared

Undergraduates only

Single gendered

38 week contract

Shared room

Communal Bathroom

Catered pay-as-you-go with a shared pantry

Parking available

Off campus

Student bar 8Barg, TV/common room, computer room, and squash and tennis courts

Wireless and Ethernet access in all rooms



£3,058.10 (or £80.48 per week)

Band L - Founder's Shared

Undergraduates only

Single gendered

30 week contract

Shared room

Communal bathroom

Catered pay-as-you-go with a shared pantry

Wireless and Ethernet access in all rooms

**£3,440.34 (or £114.68 per week) to
£3,572.82 (or £119.09 per week)**

